

TWIN

R4W



Office of the Monroe County Surveyor
Trohn Enright-Randolph

Health Services Building
119 West 7th Street
Bloomington, IN 47404
Phone: (812) 349-2570

Dear User,

The following images were obtained in 2017 by the Office of the Monroe County Surveyor from the State Imaging and Microfilm Laboratory at the Indiana State Archives. The field notes and plats for Owen County are stored on microfilm Reel 4659 at the Indiana State Archives. Each page provided by the State Imaging and Microfilm Laboratory is approximately 18MB. Our office combined the pages by Township & Range and reduced the resulting pdfs. This process may have caused some degradation in quality. We will provide unreduced images of specific pages if required. Please contact us at 812-349-2570 or at SurveyorsOffice@co.monroe.in.us to request a higher quality image of any specific page.

The pdfs are bookmarked with the original page numbers as assigned by the State Imaging and Microfilm Laboratory.

Be prepared to provide the county name, reel number, and the required page numbers when requesting full sized images.

If you would like a DVD of an entire county, please provide us with one DVD per county along with a self-addressed, stamped envelope.

Trohn Enright-Randolph
Monroe County Surveyor

Tree	Jack-o thorn.	Leaves they bear	Inters 1132
11	A	33	11
6	S	33	15
24	S	13	15
9	A	32	35
74	A	10	35
20	S	15	30
5	S	10	4
8	A	32	4
13	S	5	12
24	S	10	12
20	S	80	39
13	A	37	35
18	A	12	35
44	S	22	35
13	S	81	11
18	A	43	35
12	S	35	44
18	A	35	35
20	A	10	42
15	S	45	20
9	S	33	6
12	A	48	9
15	S	3	38
24	A	5	47
12	S	23	47
24	A	10	16
12	S	25	20
12	A	37	16
20	S	79	26
7	A	85	31
18	West		6
12	A	86	36
18	S	5	5
5	A	25	27
30	S	45	23
30	West		24
24	A	82	13
10	S	86	7
36	East		4
10	S	75	17
12	East		32
10	S	54	11
24	S	45	27
30	A	45	25
36	A	4	10
24	S	10	31
10	A	33	39
12	S	21	31
6	East		16
36	A	82	27
10	S	73	24
10	S	74	23
20	S	54	5
9	A	36	44
12	S	62	20
18	S	65	24
18	A	75	28
15	West		19
36	A	83	16
18	S	85	10
4	A	37	32
12	S	31	18
15	S	47	12
24	A	42	45
15	A	25	36
18	S	74	26
15	A	85	15
20	S	30	14
9	A	32	13
24	S	86	14
12	S	84	15
24	A	20	26
24	S	20	21
24	A	23	32
24	East		20
12	A	5	19
20	S	17	10
12	S	35	32
15	A	30	30
15	A	20	7
12	S	10	15
20	East		15
18	A	80	24

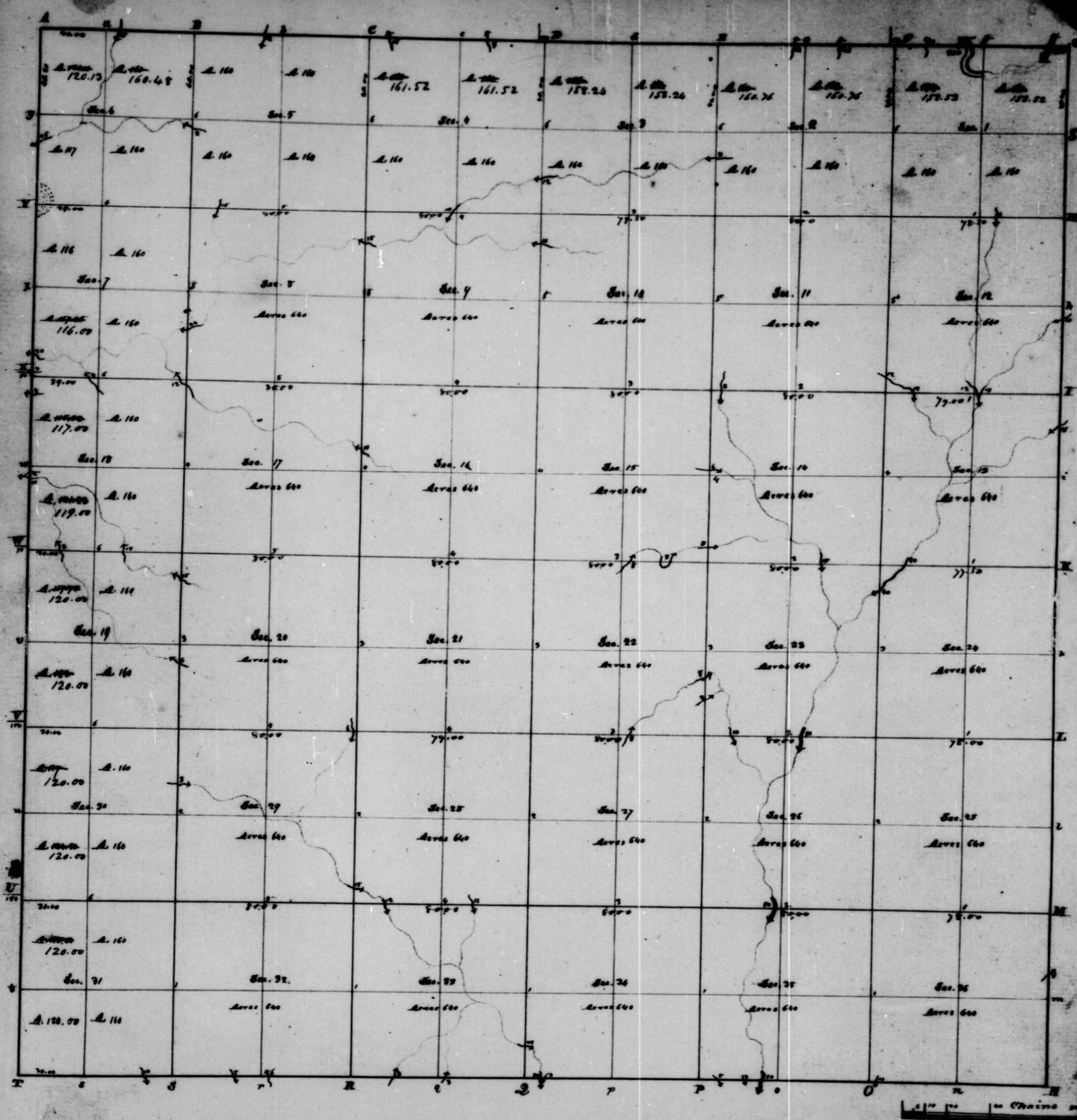

Township N^o. XII North, Range N^o. IV East 2nd M.

Surveyed by Saml Holmes

Description of the Soil on the interior Sectional lines.

Peltown Sections	Quality	Peltown Sections	Quality	Peltown Sections	Quality
23 23b	Willy land. Timber Birch, Sugar, Poplar & Alder	2 7 3	Broken land - Timber Oak, Birch, Poplar	4 8 5	Broken land - Timber Sugar, Oak, Poplar & Alder
25 36	Willy land. Timber Sugar & Oak	33 34	Willy rich land - Timber Birch, Oak & Sugar	31 32	Willy good land. Timber Sugar, Alder & Poplar
26 26	Willy land. Timber Sugar & Oak	27 24	Broken land - Timber Same	29 32	Willing land - Timber Sugar, Poplar, Oak
28 28	Willy land. Timber Sugar & Oak	27 25	Broken land - Timber Sugar, Oak, Poplar & Alder	29 30	Willy rich land. Timber Sugar, Birch, Poplar
23 24	Willy land. Timber Birch, Oak, Poplar & Sugar	29 29	Broken land - Timber Sugar, Oak, Poplar & Alder	30 31	Willy land. Timber Sugar, Oak, Poplar & Alder
12 24	Willy land. Timber Sugar, Oak, Poplar	21 22	Willy land. Timber Birch, Oak, Poplar & Sugar	20 29	Willy land. Timber Sugar & Alder
13 13	Willy land. Timber Sugar, Oak, Poplar	15 22	Willy land. Timber Birch, Oak, Poplar & Sugar	19 30	Willy land. Timber Sugar & Alder
11 12	Willy land. Timber Sugar, Oak, Poplar	15 16	Willy land. Timber Birch, Oak, Poplar & Sugar	19 20	Willy rich land. Timber Sugar, Oak, Poplar & Alder
1 12	Willy land. Timber Sugar, Oak, Poplar	10 15	Broken rich land. Timber Sugar, Oak, Poplar & Alder	17 20	Willy land. Timber Sugar, Oak, Poplar & Alder
1 2	Willy land. Timber Sugar, Oak, Poplar	9 10	Willy rich land. Timber Same	18 19	Willy land. Timber Sugar, Oak, Poplar & Alder
26 26	Willy land. Timber Sugar, Oak, Poplar	3 4	Broken land. Timber Same	17 18	Willy land. Timber Sugar, Oak, Poplar & Alder
26 27	Willy land. Timber Sugar, Oak, Poplar	32 33	Willy land. Timber Sugar, Oak, Poplar & Alder	8 17	Willy land. Timber Sugar, Oak, Poplar & Alder
26 28	Willy land. Timber Sugar, Oak, Poplar	25 33	Broken land. Timber Sugar, Oak, Poplar & Alder	7 15	Willy land. Timber Sugar, Oak, Poplar & Alder
23 26	Broken rich land. Timber Birch & Sugar	28 29	Broken land. Timber Oak, Birch, Poplar & Alder	7 8	Willy rich land. Timber Sugar, Oak, Poplar & Alder
27 27	Willy land. Timber Sugar, Oak, Poplar & Alder	21 25	Willy & Stony land. Timber Sugar, Poplar & Alder	5 8	Willy rich land. Timber Sugar, Oak, Poplar & Alder
28 28	Willy land. Timber Sugar, Oak, Poplar & Alder	20 21	Willy land. Timber Sugar, Oak, Poplar & Alder	6 7	Willy rich land. Timber Sugar, Oak, Poplar & Alder
28 29	Willy land. Timber Sugar, Oak, Poplar & Alder	16 21	Willy rich land. Timber Sugar, Oak, Poplar & Alder	5 5	Willy rich land. Timber Sugar, Oak, Poplar & Alder
28 30	Willy land. Timber Sugar, Oak, Poplar & Alder	16 17	Willy rich land. Timber Sugar, Oak, Poplar & Alder		
28 31	Willy land. Timber Sugar, Oak, Poplar & Alder	9 16	Willy land. Timber Sugar, Oak, Poplar & Alder		
28 32	Willy land. Timber Sugar, Oak, Poplar & Alder	9 17	Willy land. Timber Sugar, Oak, Poplar & Alder		

T. N. 10 AR. N. 4 W 2nd Mer. Ind.

12 W 3.50

15 E. 3.30

19 W. 5.19

South 3.17

11 W 2.82

16 W 6.82

120 W 3.17

132 W 2.52

137 W 2.17

12 W 2.71

110 W 10.00 To Township line.

South 606 distance on the South E. side of R. to 1/4
Sec. cor.

Friday May 19. 1820

Surveyed by
Alex. Holmes L.S.

I certify that the foregoing Transcript of the field
notes of Township No 10 AR. N. 4 W of the
2nd Mer. Ind. has been compared with the
Original notes in this Office & found to be
correct.

Surveyor General's Office.

Cincinnati Dec. 15. 184

Sur. Genl.

Township No 11. South of Range No 4 West 2nd Mer. Ind.

Ch. Lk.

South Boundary.

May 2nd 1811 From the cor of T. 10 N. 4 W. 15 W
East On a Random line On the South B. of Sec. 31.
T. 11. AR. 4 W.

30.00 Set a temporary 1/4 Sec post.

55.00 A Brook 10 mts. wide, course S. E.

70.00 Set a temporary post for the cor of Sec. 31 & 32
The land on this line generally hilly & rich, Timber
Sugar Beech Ash, Oak, &c.

East On a Random line On the South B. of Sec. 32.
T. 11. AR. 4 W.

27.00 A Brook 5 mts. wide, course S. E.

40.00 Set a temporary 1/4 Sec post

43.00 A Brook 6 mts. wide, course S. W.

80.00 Set a temporary post for the cor of Sec. 32 & 33.
Land & Timber same.

East On a Random line between Sec. 4 & 33.
" " " " On the South B. of Sec. 33.
T. 11. AR. 4 W.

23.00 A Brook 3 mts. wide, course N. E.

40.00 Set a temporary 1/4 Sec post.

43.00 A Brook 3 mts. wide, course N.

80.00 Set a temporary post for the cor of Sec. 33 & 34.
Land & Timber same.

East On a Random line between Sec. 3 & 34.
" " " " On the South B. of Sec. 34.
T. 11. AR. 4 W.

7.50 A Brook 30 mts. wide, course S.

10.00 " 100 30 " " "

40.00 Set a temporary 1/4 Sec post.

T. N. N. R. No. 4772nd Mer Ind.

80.00 Set a temp post for the cor of Sec 34 & 35.
Land & timber same.

East On a Random line between Secs 2 & 35.
" " " " On the South Bdy of Sec 35.
T. N. N. R. 477

10.00 A Brook 5 links wide, corner Sec.

25.00 " Do. 5 " " "

32.00 " Do. 50 " " "

40.00 Set a temp post for the cor of Sec 35 & 36.

80.00 " " " " post for the cor of Sec 35 & 36.
Land & timber same; Timber Buck Sugar & Oak

East On a Random line On the South Bdy of Sec 36.
T. N. N. R. 477

2.00 A Brook 10 links wide, corner Sec.

40.00 Set a temp post for the cor of Sec 36 & 37.

80.00 Intersect the N. 15 Range line 6 ch. North of corner. Located & marked the line.

West On the True line On the South Boundary of Sec 36.
T. N. N. R. 477

40.00 Set the temp post for the cor of Sec 36 & 37 on the true line from which,
Buck 16 in dia. bears N 55 E. 15 lbs dist, 80
Oak 16 " " " N 10 W 24 " "

80.00 Set the temp post on the true line for the cor of Sec 35 & 36 from which,
Buck 16 in dia. bears N 61 E. 14 lbs dist, 80
Oak 16 " " " N 35 W 24 " "

East On the True line On the South Bdy of Sec 35.
T. N. N. R. 477

40.00 Set the temp post for the cor of Sec 35 & 36 on the true line from which,

T. N. N. R. No. 4772nd Mer Ind.

Sugar 10 in dia. bears N 85 W. 50 lbs dist, 80
80.00 Set the temp post on the true line for the cor of Sec 34 & 35 from which,
Sugar 12 in dia. bears N 88 E. 20 lbs dist, 80
Buck 16 " " " N 72 W. 19 " "

West On the True line On the South Boundary of Sec 34.
T. N. N. R. 477

40.00 Set the temp post for the cor of Sec 34 & 35 on the true line from which,
Dogwood 5 in dia. bears N 80 W. 8 lbs dist, 80
Buck 5 " " " N 3 E. 15 " "

80.00 Set a post temp on the true line for the cor of Sec 33 & 34 from which,
Buck 18 in dia. bears N 70 W. 8 lbs dist, 80
Oak 16 " " " N 56 E. 24 " "

West On the True line between Secs 4 & 33.
" " " " On the South Bdy of Sec 33.
T. N. N. R. 477

40.00 Set a temp post for the cor of Sec 33 & 34 on the true line from which,
Maple 16 in dia. bears N 56 E. 25 lbs dist, 80
Sugar 18 " " " N 56 W. 25 " "

80.00 Set a post for the cor of Sec 32 & 33 On the true line from which,
Dogwood 6 in dia. bears N 66 W. 2 lbs dist,
under an Oak 16 in dia. bears N 52 E. 38 lbs dist.

West On the True line On the South Boundary of Sec 32.
T. N. N. R. 477

40.00 Set the temp post for the cor of Sec 32 & 33 on the true line from which,
Sugar 18 in dia. bears N 75 E. 7 lbs dist, 80
Oak 24 " " " N 75 W. 12 " "

80.00 Set a post for the cor of Sec 31 & 32 from which,
Buck 8 in dia. bears N 85 E. 27 lbs dist, 80

T. N. 11. N. R. N. 4. 11. 2nd Mer. Ind.

Heik 18 in air: bears N 33 W. 11 W. dist.

- West On the line on the East Boundary of Sec 31
T. 11. N. R. 4. 11.
- 40.00 Set a 1/4 section from white,
Dogwood 6 in air: bears N 42 E. of the dist. 80
Beck 12 " " " N 56 W. 31 " "
- 70.00 To the cor of T. 10 N. 11. N. R. 4. 11.

Surveyed by
Alex. Holmes D.S.

East Boundary

- May 3. 1811 From the cor of T. 10 N. 11. N. R. 4. 11.
- North On the East Boundary of sec. 36. T. 11. N. R. 4. 11.
- 40.00 Set a 1/4 section from white,
Beck 17 in air: bears N 65 W. 14 W. dist. 80
Do. 3 " " " N 66 E. 10 " "
- 54.00 At Brook 8 W. mid, corner N. E.
- 80.00 Set apart for the cor of sec. 25 & 36 from white,
Beck 3 in air: bears N 13 E. 14 W. dist. 80
Dogwood 3 " " " N 41 W. 13 " "
Good Beck land.

- North On the East B. of sec. 25 T. 11. N. R. 4. 11.
- 16.50 An Oak 24 in air.
- 40.00 Set a 1/4 section from white,
Dogwood 3 in air: bears N 23 E. 15 W. dist. 80
Beck 4 " " " N 65 W. 31 " "
- 80.00 Set apart for the cor of sec. 24 & 25 from white,
Beck 6 in air: bears N 5 E. 11 W. dist. 80
Do. 5 " " " N 23 W. 12 " "
Sand & timber same

T. N. 11. N. R. N. 4. 11. 2nd Mer. Ind.

- North On the East Boundary of sec. 24. T. 11. N. R. 4. 11.
- 40.00 Set a 1/4 section from white,
Beck 5 in air: bears N 33 W. 12 W. dist. 80
Do. 6 " " " N 31 E. 20 " "
- 80.00 Set apart for the cor of sec. 13 & 24 from white,
Beck 14 in air: bears N 3 E. 22 W. dist. 80
Do. 4 " " " N 10 E. 21 " "
Good Beck land.

- North On the East Boundary of sec. 13. T. 11. N. R. 4. 11.
- 40.00 Set a 1/4 section from white,
Beck 4 in air: bears N 14 W. 22 W. dist. 80
Do. 6 " " " N 71 E. 5 " "
- 61.00 At Beck 16 in air
- 64.00 " Brook 12 in air: bears, corner N. W.
- 76.00 Do. 14 " " " S. W.
- 80.00 Set apart for the cor of sec. 12 & 13 from white,
Beck 16 in air: bears N 47 W. 16 W. dist. 80
Do. 16 " " " East. 60 " "
Poor Beck land.

- North On the East Boundary of sec. 12. T. 11. N. R. 4. 11.
- 29.50 An Oak 48 in air.
- 33.50 " Brook 10 in air: bears, corner N. W.
- 40.00 Set a 1/4 section from white,
Beck 3 in air: bears N 39 E. 22 W. dist. 80
Dogwood 3 " " " N 33 W. 23 " "
- 80.00 Set apart for the cor of sec. 1 & 12 from white,
Beck 9 in air: bears N 53 E. 9 W. dist. 80
Do. 4 " " " N 48 W. 16 " "
Pretty Good Beck land.

- North On the East B. of sec. 1. T. 11. N. R. 4. 11.

T. N. H. R. No. 477 2nd Mrs. And.

- 23.00 At Walnut 15 in dia.
 40.00 Set a 74 sap post from white.
 Bent 17 in dia. bears S28 N 23 W. dist. 80
 Ls. 5 " " " " N19 E 13 " "
 80.00 Set apart for the cor of S. 11 112 N. R. 3 112 W
 from white. Bent 5 in dia. bears S27 E 27 W. dist.
 and a Ls. 14 " " " " N45 W. 17 " "
 Sand low Timber Bent Sugar & Poplar.

North Boundary.

- West On the South Bdy of Sw. 36 T. 12 N. R. 4 W.
 10.00 At Brook 200 lbs mid, corner S.
 40.00 Set a 74 sap post from white.
 Bent 14 in dia. bears S34 N 14 W. dist. 80
 Ls. 13 " " " " N30 E 17 " "
 44.25 At Brook 200 lbs mid, corner NW.
 65.50 " Ls. 10 " " " " N. W.
 80.00 Set apart for the cor of Sw. 35 & 36 from white.
 Bent 5 in dia. bears S78 N 26 W. dist. 80
 Oak 14 " " " " N74 E 10 " "
 Good land Timber Sugar Bent & Hickory.

- West On the South Bdy of Sw. 35 T. 12 N. R. 4 W.
 25.00 At Brook 20 lbs mid, corner N.
 40.00 Set a 74 sap post from white.
 Bent 5 in dia. bears S75 N 8 W. dist. 80
 Ls. 3 " " " " N44 W 10 " "
 43.50 At Brook 12 lbs mid, corner N.
 81.00 Set apart for the cor of Sw. 34 & 35 from white.
 Bent 12 in dia. bears S70 E 4 W. dist. 80
 Poplar 30 " " " " N27 W. 49 " "
 Good land Timber Sugar Bent & Oak

T. N. H. R. No. 477 2nd Mrs. And.

- West On the South Boundary of Sw. 34 T. 12 N. R. 4 W.
 40.00 Set a 74 sap post from white.
 Bent 16 in dia. bears N44 E 18 W. dist. 80
 Chastanot 12 " " " " S52 W. 14 " "
 80.00 Set apart for the cor of Sw. 33 & 34 from white.
 Bent 12 in dia. bears S82 N 34 W. dist. 80
 Ls. 5 " " " " N25 E 26 " "
 Poor hilly Bent land.

- West On the South Boundary of Sw. 33 T. 12 N. R. 4 W.
 24.50 At Brook 8 lbs mid, corner NW.
 40.00 Set a 74 sap post from white.
 Bent 18 in dia. bears S75 N 8 W. dist. 80
 Ls. 3 " " " " N18 E 39 " "
 70.00 At Brook 15 lbs mid, corner NW.
 80.00 Set apart for the cor of Sw. 32 & 33 from white.
 Sugar 12 in dia. bears S26 E 11 W. dist. 80
 Ls. 9 " " " " N26 W. 13 " "
 Poor hilly Bent land.

- West On the South Bdy of Sw. 32 T. 12 N. R. 4 W.
 40.00 Set a 74 sap post from white.
 Bent 16 in dia. bears N43 N. 22 W. dist. 80
 Ls. 12 " " " " N41 E 18 " "
 48.00 At Brook 12 lbs mid, corner S.
 80.00 Set apart for the cor of Sw. 31 & 32 from white.
 Ls. 10 in dia. bears N60 E 9 W. dist. 80
 Bent 4 " " " " S22 W. 17 " "
 Hilly Bent land.

- West On the South Bdy of Sw. 31 T. 12 N. R. 4 W.
 34.50 At Brook 15 lbs mid, corner S.W.
 40.00 An Oak 16 in dia. stands for the cor. of S. 31 & 32

T. No. 11. N.R. No. 477 2nd Mus. Ind.

Beck 9 in dia: bears N 47 E. 8 lks dist. S. a
 Sugar 10 " " " N 53 W. 18 " "
 66.00 A Locak 40 links midy. Course S. W.
 77.50 Set apart for the cov of Sec. 13, 14, 23 & 24 from which
 Beck 15 in dia: bears S 74 W. 21 lks dist. S. a
 Sugar 18 " " " S 71 E. 44 " "
 Hilly land; Tintu Beck Sugar Poplar. S.

North Between Sec. 13 & 14
 40.00 Set a 74 Sec post from which
 Beck 18 in dia: bears West 9 lks dist. S. a
 Loc. 12 " " " N 86 E. 36 " "
 65.00 A Poplar 30 in dia:
 80.00 Set a temp^y post for the cov. of Sec. 11, 12, 13 & 14
 Land very hilly; Tintu Sugar, Oak & Poplar.
 April 19 1844.

East On a Random line between Sec. 12 & 13.

West On the True line between Sec. 12 & 13.
 36.50 A Brook 15 links midy. Course S.
 39.00 " Loc. 10 " " " S. E.
 40.00 Set a 74 Sec post from which
 Beck 18 in dia: bears N 33 W. - lks dist. S. a
 Ironwood 6 " " " S 33 E. 18 " "
 69.00 A Brook 12 lks midy. Course S. E.
 79.00 Set apart for the cov of Sec. 11, 12, 13 & 14 from which
 W Oak 36 in dia: bears N 43 E. 36 lks dist. S. a
 Sugar 15 " " " N 22 W. 58 " "
 Hilly land; Tintu Oak Sugar & Poplar.

North Between Sec. 11 & 12
 5.00 A Brook 12 lks midy. Course S. E.

T. No. 11. N.R. No. 477 2nd Mus. Ind.

40.00 Set a 74 Sec post from which
 Hick 18 in dia: bears S 5 E. 5 lks dist. S. a
 Ash. 5 " " " N 28 W. 27 " "
 80.00 Set a temp^y post for the cov of Sec. 1, 2, 11 & 12
 Hilly Beck land.

East On a Random line between Sec. 1 & 12

West On the True line between Sec. 1 & 12.
 28.00 A Brook 6 lks midy. Course S.
 40.00 Set a 74 Sec post from which on
 Ash 15 in dia: bears N 12 W. 35 lks dist. S. a
 W Oak 44 " " " S 22 W. 38 " "
 78.50 Set apart for the cov of Sec. 1, 2, 11 & 12 from which
 Ash 24 in dia: bears S 15 E. 33 lks dist. S. a
 Beck 24 " " " West 23 " "
 Hilly Beck & Oak land.

North Between Sec. 1 & 12
 40.00 Set a 74 Sec post from which
 Hick 30 in dia: bears N 45 E. 23 lks dist. S. a
 Beech 30 " " " North 24 " "
 80.00 Intersect the N.R. boundary 50 lks East of the post cov
 of Sec. 35 & 36. T. 12 N.R. 11 W and set a post for the
 cov of Sec. 1 & 12 from which
 Beck 12 in dia: bears N 61 W. 50 lks dist. S. a
 Loc. 12 " " " N 44 E. 23 " "
 Hilly Beck & Oak land.

North Between Sec. 33 & 34
 40.00 Set a 74 Sec post from which
 W Oak 24 in dia: bears N 82 W. 17 lks dist. S. a
 Gum 10 " " " S 86 E. 7 " "

T. N. 11. N. R. N. 4 W. 2nd Mer. Ind.

80.00 Set a temp. post for the cov of Sec. 26, 27, 34 & 35
Hilly Buck & Oak land.

East On a Random line between Sec. 26 & 35.

West On the true line between Sec. 26 & 35.

40.00 Set a 1/4 sec post from which
Walnut 12 in diam bears N 50 E. 70 lks dist, & a
Oak 12 " " S 36 W. 72 " "

43.50 A Brook 50 lks mid, corner S.

80.00 Set a post for the cov of Sec. 26, 27, 34 & 35 from which
Hick 18 in diam bears N 43 E. 17 lks dist, & a
Ironwood 6 " " West 8 " "
Very hilly land; Timber Buck & Sugar.

North Between Sec. 26 & 27.

40.00 Set a 1/4 sec post from which
W Oak 36 in diam bears East 4 lks dist, & a
Buck 10 " " S 75 W. 17 " "

80.00 Set a temp. post for the cov of Sec. 22, 23, 26 & 27
Very hilly land; Timber Buck & Sugar.

East On a Random line between Sec. 23 & 26.

West On the true line between Sec. 23 & 26.

33.00 A Brook 50 lks mid, corner S.

40.00 Set a 1/4 sec post from which a
Buck 20 in diam bears S 37 E. 16 lks dist, & a
Hick 18 " " N 53 W. 11 " "

67.00 A Brook 10 lks mid, corner S.E.

80.00 Set a post for the cov. of Sec. 22, 23, 26 & 27 from which
a Hick 13 in diam bears N 45 W. 9 lks dist, & a
Oak 12 " " N 58 E. 20 " "

Comp.

T. N. 11. N. R. N. 4 W. 2nd Mer. Ind.

Ch. Sec.

Broken Rich land. Timber Buck & Sugar.

North Between Sec. 22 & 23. Apr. 20. 1814

12.50 A Brook 8 lks mid, corner N.E.

21.00 " Oak 8 " " N.E.

40.00 Set a 1/4 sec post from which
Buck 12 in diam bears East 32 lks dist, & a
Oak 10 " " S 47 W. 9 " "

80.00 Set a post for the cov of Sec. 14, 15, 22 & 23.

Land broken Timber Buck & Sugar; land rich

East On a Random line between Sec. 14 & 23.

West On the true line between Sec. 14 & 23.

26.00 A Brook 15 lks mid, corner S.E.

40.00 Set a 1/4 sec post from which
Buck 24 in diam bears N 36 W. 35 lks dist, & a
Sugar 24 " " S 62 E. 28 " "

80.00 Set a post for the cov of Sec. 14, 15, 22 & 23 from which
a Buck 24 in diam bears N 42 E. 29 lks dist, & a
Oak 15 " " N 38 W. 19 " "
Land & Timber same.

North Between Sec. 14 & 15.

7.00 A Brook 8 lks mid, corner E.

40.00 Set a 1/4 sec post from which
Oak 24 in diam bears N 45 E. 27 lks dist, & a
W Oak 30 " " N 45 W. 25 " "

43.00 A Brook 6 lks mid, corner E.

55.00 A Poplar 24 in diam

80.00 Set a temp. post for the cov of Sec. 10, 11, 14 & 15.
Broken Stony land.

T. N. 11. N. R. N. 4 W. 2nd Mer. Ind.

7.00 A Brook 8 lks mid, corner C.
40.00 Set a 1/4 sec post from whike,

East On a Random line between Sec. 11 & 14

West On the true line between Sec. 11 & 14

40.00 Set a 1/4 sec post from whike,
Oak 24 in dia. bears N 15 W. 18 lks dist. 8 a
Nicky 9, " " N 82 E. 35, " "

72.00 A Brook 8 lks mid, corner I.

80.00 Set a post for the cor of Sec. 10, 11, 14 & 15 from whike,
Sugar 24 in dia. bears N 37 W. 8 lks dist. 8 a
Nicky 8, " " N 38 E. 8, " "
Brook Stony land, Timber same.

East On a Random line between Sec. 2 & 11.

West On the true line between Sec. 2 & 11.

40.00 Set a 1/4 sec post from whike,
Buck 15 in dia. bears S 81 W. 5 lks dist. 8 a
Poplar 18, " " N 43 E. 20, " "

80.00 Set a post for the cor of Sec. 2 & 11 11 & 12 from whike,
Buck 15 in dia. bears N 25 W. 1 lks dist. 8 a
Loc. 20, " " S 22 W. 4, " "
Land & timber same.

North Between Sec. 21 & 3.

2.50 A Poplar 24 in dia.

24.00 A Brook 8 lks mid, corner W.

40.00 Set a 1/4 sec post from whike,
Nicky 10 in dia. bears N 33 W. 39 lks dist. 8 a
Buck 12, " " S 27 E. 31, " "

80.00 Intersect the N Boundary at the post cor of Sec.

T. N. 11. N. R. N. 4 W. 2nd Mer. Ind.

34 & 35 T. N. 12. N. R. 4 W.

Land Broken Timber Oak, Beech & Poplar.

North Between Sec. 33 & 34 April 21 1814

12.00 A Brook 25 lks mid corner A.

40.00 Set a post for the cor of Sec. 27, 28, 33 & 34 from whike,
Ironwood 6 in dia. bears East 16 lks dist. 8 a
Oak 36, " " N 82 W. 27, " "

80.00 Set a temporary post for the cor of Sec. 27, 28, 33 & 34
Willy land, Timber Beech Oak & Sugar.

East On a Random line between Sec. 27 & 34

West On the true line between Sec. 27 & 34

40.00 Set a 1/4 sec post from whike,
Sugar 12 in dia. bears S 75 E. 16 lks dist. 8 a
Beech 20, " " N 45 W. 10, " "

80.00 Set a post for the cor of Sec. 27, 28, 33 & 34 from whike,
Sugar 18 in dia. bears N 45 E. 27 lks dist. 8 a
Loc. 20, " " S 80 W. 26, " "
Land & Timber same.

North Between Sec. 27 & 28.

40.00 Set a 1/4 sec post from whike,
Oak 10 in dia. bears S 73 W. 11 lks dist. 8 a
Beech 10, " " S 74 E. 13, " "

61.50 A W Oak 36 in dia.

80.00 Set a temporary post for the cor of Sec. 21, 22, 27 & 28.
Land Broken Timber Beech, Oak, Sugar, &c.

East On a Random line between Sec. 22 & 27

West On the true line between Sec. 22 & 27

North Between Secs 37 & 4.

17.00 At Brook 12 links mid, corner W

40.00 Set a 1/4 sec post from which,
Beck 36 in dia: bears N 83 E. 16 links dist. & a
Sugar 18, " " S 85 W 19, "

68.00 A Sugar 24 in dia:

80.00 Intersect the W Boundary 100 lks East of the post
cor of Secs 33 & 34 T. 12 N. R. 4 W and set a post
for the cor of Sec 37 & 4 from which,
Sugar 18 in dia: bears S 74 W 10 lks dist. & a
Co. 20 " " N 33 E 38, "
Sand Broken Timber Sugar, Oak, & Poplar.

North Between Secs 32 & 33.

40.00 Set a 1/4 sec post from which

Ironwood 4 in dia: bears N 37 W 22 lks dist. & a
Beck 12 " " S 30 E. 18, "80.00 Set a temp. post for the cor of Secs 28, 29, 32 & 33.
Hilly land; Timber Beck, Sugar, Poplar &c.

East On a Random line between Secs 28 & 33.

West On the true line between Secs 28 & 33.

25.00 At Brook 12 lks mid, corner S

40.00 Set a 1/4 sec post from which,
Oak 24 in dia: bears S 62 E. 10 lks dist. & a
Beck 20 " " N 56 W 29, "

46.00 At Brook 12 lks mid, corner S

80.00 Set a temp. post for the cor. of Secs 28, 29, 32 & 33 from which,
Beck 12 in dia: bears N 77 E. 22 lks dist. & a
Co. 9, " " S 80 W 22, "
Sand Broken Timber Yellow, Green briars, &c.

North Between Secs 28 & 29

6.00 At Brook 15 links mid, corner W

40.00 Set a 1/4 sec post from which,
Sugar 15 in dia: bears N 47 E. 9 lks dist. & a
Beck 20, " " N 79 W 18, "80.00 Set a temp. post for the cor of Secs 20, 21, 28 & 29.
Broken land; Timber Oak, Beck, Poplar.
April 25, 1844

East On a Random line between Secs 21 & 28.

West On the true line between Secs 21 & 28.

40.00 Set a 1/4 sec post from which,

Sugar 8 in dia: bears S 68 E. 13 lks dist. & a
Sugar 15, " " N 32 W 30, "79.00 Set a post for the cor of Secs 20, 21, 28 & 29 from which,
Beck 9 in dia: bears S 77 W. 28 lks dist. & a
Co. 9, " " N 83 E. 21, "
Hilly & Stony land. Timber Sugar & Poplar.

North Between Secs 20 & 21

21.50 At Poplar 20 in dia:

40.00 Set a 1/4 sec post from which,
Sugar 12 in dia: bears S 42 E. 44 lks dist. & a
Beck 15, " " N 25 W 36, "80.00 Set a temp. post for the cor of Secs 16, 17, 20 & 21
Sand & Timber same.

East On a Random line between Secs 16 & 21

West On the true line between Secs 16 & 21

40.00 Set a 1/4 sec post from which,
Sugar 20 in dia: bears S 30 W. 8 lks dist. & a

T. N. 11. N. R. No. 477 2nd Mer.

Ashe 30 in dia: bears N 25 E 16 lbs dist. & a
 80,00 Set a post for the cor of Sec 16. 17. 20 121 from which,
 Walnut 18 in dia: bears N 77 W 15 lbs dist. & a
 Sassafras 12 " " N 33 E 25 " "
 Sand & Timber same

North Between Sec 16 & 17
 40,00 Set a 1/4 sec post from which,
 Sugar 18 in dia: bears S 74 W 29 lbs dist. & a
 Do. 15 " " " N 85 E 18 " "
 48,00 At Brook 10 lbs mid, course N. W.
 80,00 Set a temp post for the cor of Sec 8. 9. 16 & 17.
 Hilky rich land; Timber Oak, Poplar, Hick, Sugar
 & Beech, &c.

East On a Random line between Sec. 9 & 16.

West On the Same line between Sec. 9 & 16.
 40,00 Set the 1/4 sec post from which,
 W Oak 8 in dia: bears N 10 W 14 lbs dist. & a
 Sugar 8 " " " N 52 E 18 " "
 80,00 Set a post for the cor of Sec 8. 9. 16 & 17 from which
 Poplar 36 in dia: bears N 46 W 22 lbs dist. & a
 Elm 20 " " " S 78 E 28 " "
 Sand & Broken Timber Oak, Poplar, Hick, Beech
 Sugar &c.

North Between Sec 8 & 9 T. 11.
 40,00 Set a 1/4 sec post from which
 Beech 20 in dia: bears S 30 E 14 lbs dist. & a
 Do. 9 " " " N 32 W 15 " "
 65,00 At Brook 15 lbs mid, course N. W.
 80,00 Set a temp post for the cor of Sec 4. 5. 8 & 9.

T. N. 11. N. R. No. 477 2nd Mer. Ind.

Hilky land; Timber Oak, Beech, Sugar, Poplar,

East On a Random line between Sec. 4 & 9.

West On the Same line between Sec. 4 & 9.
 40,00 Set a 1/4 sec post from which,
 Beech 20 in dia: bears N 10 W 12 lbs dist. & a
 Do 15 " " " N 45 W 70 " "
 This post stands in a Brook 15 lbs mid, course N. W.
 80,00 Set a post for the cor of Sec 4. 5. 8 & 9 from which,
 Beech 24 in dia: bears N 44 W 18 lbs dist. & a
 Do 18 " " " N 66 E 20 " "
 Sand & Timber same as last mile.

North Between Sec 4 & 5
 16,50 At Beech 36 in dia:
 40,00 Set a 1/4 sec post from which
 Beech 24 in dia: bears S 86 W 14 lbs dist. & a
 Sugar 12 " " " S 84 E 15 " "
 80,00 Struck the post cor of Sec 3. 2. 13. 3 T. 12 N. R. 477.
 Broken land; Timber Sugar Oak & Poplar &c.
 April 24. 1814

North Between Sec 31 & 32
 Begun in fallen timber
 37,00 Through " "
 40,00 Set a 1/4 sec post from which
 Beech 24 in dia: bears N 20 W 26 lbs dist. & a
 Hick 24 " " " S 20 E 21 " "
 80,00 Set a temp post for the cor of Sec 29. 30. 31 & 32
 Just p of this mile is pretty good land.
 Timber Sugar Walnut, Poplar &c.

T. N. H. R. N. 477 Dnd March

East On a Random line between Sec 29 & 32

West On a True line between Sec 29 & 32

40.00 Set a 7/4 Sec post from which

Sugar 22 in dia^r trees N 79 W 14 the dist. 8 a
Hick 18 " " S 75 E 15 "80.00 Set a post for the cor of Sec 29 30 31 32 from which
Beck 20 in dia^r trees S 72 W 25 the dist. 8 a
Do. 18 " " N 81 E 32 "
Sandy muddling Timber Sugar, Poplar, Oak, &

West Between Sec 30 & 31

40.00 Set a 7/4 Sec post from which

Hick 20 in dia^r trees S 75 E 20 the dist. 8 a
Beck 9 " " S 78 W 33 "70.00 Intersect the West Boundary 150 links South of the
post cor of Sec 25 36 T. N. H. R. 577 and set a
" " " 30 31 from which
Sugar 12 in dia^r trees N 44 E 6 the dist. 8 a
Beck 9 " " S 64 W 24 "
Hilly rich land; Timber same.

North Between Sec 30 & 29

25.50 A Poplar 30 in dia^r "

40.00 Set a 7/4 Sec post from which a

Beck 24 in dia^r trees N 23 W 32 the dist. 8 a
Oak 24 " " East 20 " "80.00 Set a temp^y post for the cor of Sec 19 20 29 & 30.
Hilly rich land; Timber Sugar, Beck, Poplar.

East On a Random line between Sec 20 & 29

West On the True line between Sec 20 & 29

T. N. H. R. N. 477 Dnd Mar. Ind.

100 At Brook 6 the mid, corner S.

40.00 Set a 7/4 Sec post from which

Beck 36 in dia^r trees N 86 W 24 the dist. 8 a
Sugar 15 " " S 35 E 26 "80.00 Set a post for the cor of Sec 19 20 29 & 30 from which
Poplar 20 in dia^r trees N 45 W 25 the dist. 8 a
Sugar 18 " " S 76 E 27 "
Hilly rich land; Timber Beck, Sugar, Poplar, &

West Between Sec 19 & 30

40.00 Set a post for the cor of Sec 19 from which

Sugar 9 in dia^r trees N 40 E 12 the dist. 8 a
Poplar 20 " " N 45 W 27 "70.00 Intersect the West Boundary 100 the South of the
post cor of Sec 24 & 25 T. N. H. R. 577 & set a
" " " 19 & 30 from which
Beck 30 in dia^r trees N 44 E 4 the dist. 8 a
Poplar 12 " " N 53 W 27 "
Rich Sugar & Walnut land.

North Between Sec 19 & 20

27.00 At Brook 6 the mid, corner N. W.

40.00 Set a 7/4 Sec post from which

Sugar 12 in dia^r trees N 8 W 21 the dist. 8 a
Do 20 " " N 7 E 19 "

77.50 At Brook 15 the mid, corner N. W.

80.00 Set a temp^y post for the cor of Sec 17 18 19 & 20
Hilly rich land; Timber Sugar Oak & Poplar.

East On a Random line between Sec 17 & 20

West On the True line between Sec 17 & 20

40.00 Set a 7/4 Sec post from which

T. No 11. N. R. No 57 2nd Mer. Ind.

Wick 15 in dia: bears N 88 E. 30 lbs dist. & a
 Poplar 8 " " " N 84 W 29 " "
 80.00 Set a post for the cov of Sec. 17. 18. 19 & 20 from which
 Buck 18 in dia: bears N 78 E. 9 lbs dist. & a
 Sugar 20 " " " N 55 W 20 " "
 Kelly land Timber Oak, Sugar Hickory, Poplar &c

West Between Sec. 18 & 19. Apr 25. 1814

26.50 At Brook 15 lbs mid, corner N. W.
 40.00 Set a post for the cov of 1/4 sec post from which
 Sugar 12 in dia: bears S 3 E. 7 lbs dist. & a
 Mulberry 6 " " " N 60 W 35 " "
 55.00 At Brook 8 lbs mid, corner N. W.
 70.00 Intersect the West Boundary & fall 75 lbs south
 of the post cov of sec. 18 & 19. T. 11. N. R. 5 W and set
 a post for the cov of Sec. 18 & 19 from which
 Gum 48 in dia: bears N 33 E. 15 lbs dist. & a
 Ironwood 6 " " " N 25 W 22 " "
 Kelly land: Timber Oak, Poplar, Sugar &c

North Between Sec. 17 & 18

40.00 Set a post for the cov of 1/4 sec from which
 Sugar 12 in dia: bears N 38 W. 10 lbs dist. & a
 Sassafras 15 " " " N 30 E. 32 " "
 76.00 At Brook 12 lbs mid, corner W
 80.00 Set a temp. post for the cov of Sec. 7. 8. 17 & 18
 Sand & Timber same.

East On a Random line between Sec. 8 & 17.

West On the True line between Sec. 8 & 17.
 40.00 Set a post for the cov of 1/4 sec from which
 Buck 15 in dia: bears S 5 W 12 lbs dist. & a

T. No 11. N. R. No 4 W 2nd Mer. Ind.

Oak 24 in dia: bears N 10 E 15 lbs dist.
 80.00 Set a post for the cov of Sec. 7. 8. 17. & 18 from which
 Buck 18 in dia: bears N 45 W. 32 lbs dist. & a
 Do. 20 " " " S 32 E. 11 " "
 Kelly land: Timber Oak Buck, Sugar, Poplar.

West Between Sec. 7 & 18.

4.50 At Brook 15 lbs mid, corner N. W.
 40.00 Set a post for the cov of 1/4 sec from which
 Buck 20 in dia: bears S 80 E. 29 lbs dist. & a
 Sugar 18 " " " N 37 W 10 " "
 45.00 At Brook 8 lbs mid, corner N. W.
 69.00 Intersect the West Boundary and fall 50 lbs south
 of the post cov of Sec. 12 & 13. T. 11. N. R. 5 W. and set
 a post for the cov of Sec. 7 & 18 from which
 Elm 12 in dia: bears S 15 E. 23 lbs dist. & a
 Buck 20 " " " N 48 W 20 " "
 Sand & Timber same.

North Between Sec. 7 & 8

22.00 At Brook 25 lbs mid, corner S. W.
 40.00 Set a post for the cov of 1/4 sec from which
 Buck 15 in dia: bears N 20 E. 30 lbs dist. & a
 Do. 12 " " " N 10 W 7 " "
 80.00 Set a temp. post for the cov of Sec. 5. 6. 7 & 8.
 Sand & Timber same as last mile.

East On a Random line between Sec. 5 & 8.

West On the True line between Sec. 5 & 8.
 40.00 Set a 1/4 sec post from which
 Buck 9 in dia: bears S 53 E. 6 lbs dist. & a
 Do. 12 " " " N 48 W 9 " "

T. N. H. N. R. No 4 W 2nd Mer. Ind.

65.00 At Brook 15 links mid, course NW
 80.00 Set a post forth cor of Sec 5, 6, 7 & 8 from which
 Sugar 15 in dia: bears S 48 E 53 links dist, & a
 Do. 20 " " " N 33 W 50 " "
 Hilly rich land, Timber Sugar, Beech & Walnut,
 Poplar Oak &c.

West Between Sec 6 & 7

40.00 Set a 1/4 sec post from which,
 4 Beech 15 in dia: bears S 3 E 38 lks dist, & a
 Do. 24 " " " N 5 E 47 " "
 61.00 To a Swamp
 69.10 Intersect the West Boundary at the post cor of
 Sec 1 & 2 T. 11. N. R. 5 W and set a post for the cor
 of Sec 7 & 6. Hilly rich land, Timber Sugar.

North Between Sec 5 & 6.

37.00 At Brook 8 lks mid, course NW
 40.00 Set a 1/4 sec post from which,
 Beech 20 in dia: bears East 18 lks dist, & a
 Do. 18 " " " N 80 W 21 " "
 58.00 At Poplar 30 in dia:
 80.00 Intersect the North Boundary at the post cor of Sec
 31 & 32 T. 12. N. R. 4 W

Surveyed by
 Saml. Holmes. L.S.

John Hutchison & Chaintearos
 Jacob. Barnet.

North between Sec 10 & 11

24.50 a W. Oak 20 in dia:
 40.00 set a sec. post from which Poplar 36 N 4 E 19, Sugar 24 S 10 W 31
 80.00 set temp. post - Hilly land, timber Oak, Sugar, Poplar &c.

Township No 12 North of Range No 4 West 2nd Mer. Ind.

Ch. Lks.

South Boundary

West On the South Boundary of Sec 36 T. 12. N. R. 4 W.

10.00 At Brook 200 links mid, course S
 40.00 Set a 1/4 sec post from which,
 9 Beech 14 in dia: bears S 34 W 14 lks dist, & a
 Do. 13 " " " N 30 E 17 " "

44.25 At Brook 200 lks mid, course NW

65.50 At Brook 10 lks mid, " NW
 80.00 Set a post for the cor of Sec 35 & 36 from which,
 9 Beech 5 in dia: bears S 78 W 26 lks dist, & a
 W Oak 14 " " " N 74 E 10 " "
 Good land, Timber Sugar Beech & Hickory

West On the South Boundary of Sec 35 T. 12. N. R. 4 W.

25.00 At Brook 20 lks mid, course N.
 40.00 Set a 1/4 sec post from which,
 4 Beech 5 in dia: bears S 75 W 8 lks dist, & a
 Do. 3 " " " N 44 W 10 " "

43.50 At Brook 12 lks mid, course N.

80.00 Set a post for the cor of Sec 34 & 35 from which,
 Beech 12 in dia: bears S 70 E 4 links dist, & a
 Poplar 30 " " " N 27 W 49 " "
 Good land, Timber Sugar Beech & Oak.

West On the South Boundary of Sec 34 T. 12. N. R. 4 W

40.00 Set a 1/4 sec post from which,
 Beech 16 in dia: bears N 44 E 18 lks dist, & a
 Sassafras 12, " " " S 52 W 14 " "

80.00 Set a post for the cor of Sec 33 & 34 from which,
 Beech 12 in dia: bears S 82 W 34 lks dist, & a
 Do. 5 " " " N 25 E 26 " "
 Poor hilly Beech land.